

**NOVA | SUPERNOVA** LINE

 **Benelli**

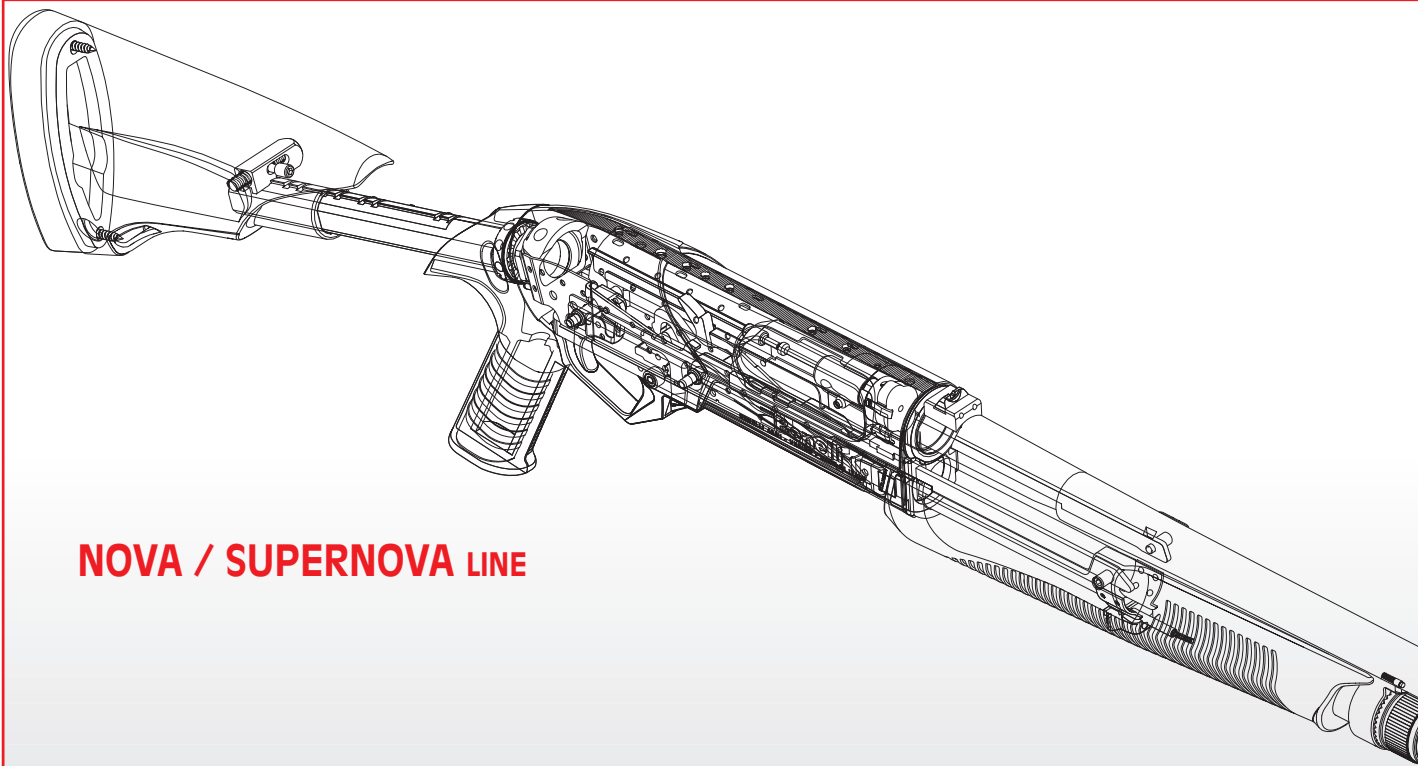

**NOVA / SUPERNOVA LINE**

 **Benelli**



## Contents

<b>USE • MAINTENANCE</b> .....	1
Basic safety rules .....	2
Presentation .....	4
Assembly Instructions .....	4
Loading Procedures .....	6
Firing the Shotgun .....	7
Cartridge Replacement - Magazine Stop Button .....	7
Unloading the Firearm .....	8
Troubleshooting .....	8
Ammunition to use .....	9
Maintenance .....	9
Disassembly of the Firearm .....	9
Firearm Assembly .....	12

### ACCESSORIES AND ADJUSTMENTS:

Drop and cast adjustment .....	14
Telescoping stock .....	16
Short tube limiter .....	16
Magazine extension tube .....	18
Long tube limiter .....	18
Internal choke .....	20
Adjusting the back-sight .....	21

### NOVA MODEL

.....	22
Ammunition to use .....	22
Magazine extension tube .....	22
Buttstock Cavity .....	22
Optional Recoil Reduction Device .....	23

<b>SPARE PARTS LISTS</b> .....	23
--------------------------------	----





## BASIC SAFETY RULES

**WARNING: PLEASE READ THIS MANUAL BEFORE HANDLING YOUR FIREARM.**

**WARNING: FIREARMS CAN BE DANGEROUS AND CAN POTENTIALLY CAUSE SERIOUS INJURY, DAMAGE TO PROPERTY OR DEATH, IF HANDLED IMPROPERLY. THE FOLLOWING SAFETY RULES ARE AN IMPORTANT REMINDER THAT FIREARM SAFETY IS YOUR RESPONSIBILITY.**

### 1. NEVER POINT A FIREARM AT SOMETHING THAT IS NOT SAFE TO SHOOT.

Never let the muzzle of a firearm point at any part of your body or at another person. This is especially important when loading or unloading the firearm. When you are shooting at a target, know what is behind it. Some bullets can travel over a mile. If you miss your target or if the bullet penetrates the target, it is your responsibility to ensure that the shot does not cause unintended injury or damage.



### 2. ALWAYS TREAT A FIREARM AS IF IT WERE LOADED.

Never assume that a firearm is unloaded. The only certain way to ensure that a firearm has the chamber empty is to open the chamber and visually and physically examine the inside to see if a round is present. Removing or unloading the magazine will not

guarantee that a firearm is unloaded or cannot fire. Shotguns and rifles can be checked by removing all rounds and by then opening and inspecting the chamber so that a visual inspection of the chamber for any remaining rounds can be made.

### 3. STORE YOUR FIREARM SO THAT CHILDREN CANNOT GAIN ACCESS TO IT.

It is your responsibility to ensure that children under the age of 18 or other unauthorized persons do not gain access to your firearm. To reduce the risk of accidents involving children, unload your firearm, lock it and store the ammunition in a separate locked location. Please note that devices intended to prevent accidents - for example, cable locks, chamber plugs, etc. - may not prevent use or misuse of your firearm by a determined person. Firearm storage in a steel gun safe may be more appropriate to reduce the likelihood of intentional misuse of a firearm by an unauthorized child or person.

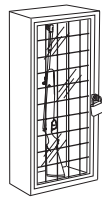

### 4. NEVER SHOOT AT WATER OR AT A HARD SURFACE.

Shooting at the surface of water or at a rock or other hard surface increases the chance of ricochets or fragmentation of the bullet or shot, which can result in the projectile striking an unintended or peripheral target.



### 5. KNOW THE SAFETY FEATURES OF THE FIREARM YOU ARE USING, BUT REMEMBER: SAFETY DEVICES ARE NOT A SUBSTITUTE FOR SAFE HANDLING PROCEDURES.

Never rely solely on a safety device to prevent an accident. It is imperative that you know and use the safety features of the particular firearm you are handling, but accidents can best be prevented by following the safe handling procedures described in these safety rules and elsewhere in the product manual.

To further familiarize yourself with the proper use of this or other firearms, take a Firearms Safety Course taught by an expert in firearms use and safety procedures.

### 6. PROPERLY MAINTAIN YOUR FIREARM.

Store and carry your firearm so that dirt or lint does not accumulate in the working parts. Clean and oil your firearm, following the instructions provided in this manual, after each use to prevent corrosion, damage to the barrel or accumulation of impurities which can prevent use of the gun in an emergency. Before loading your firearm, always check the barrel internal part and the chamber to ensure that they are clean and free from obstructions. Firing with an obstruction in the barrel or chamber can rupture the barrel and injure you or others nearby. In the event you hear an unusual noise when shooting, stop firing immediately, engage the manual safety and unload the firearm.





Make sure the chamber and barrel are free from any obstruction, like a bullet blocked inside the barrel due to defective or improper ammunition.

#### 7. USE PROPER AMMUNITION.

Only use factory-loaded, new ammunition manufactured to industry specifications: CIP (Europe and elsewhere), SAAMI® (U.S.A.). Be certain that each round you use is in the proper caliber or gauge and type for the particular firearm.

The caliber or gauge of the firearm is clearly marked on the barrels of shotguns and on the slide or barrel of pistols.

The use of reloaded or remanufactured ammunition can increase the likelihood of excessive cartridge pressures, case-head ruptures or other defects in the ammunition that can cause damage to your firearm and injury to yourself or others nearby.

#### 8. ALWAYS WEAR PROTECTIVE GLASSES AND EARPLUGS WHEN SHOOTING.

The chance that gas, gunpowder or metal fragments will blow back and injure a shooter who is firing a gun is rare, but the injury that can be sustained in such circumstances can be severe, including the possible loss of eyesight. A shooter must always wear impact resistant shooting glasses when firing any firearm. Earplugs or other high-quality hearing protectors help reduce the chance of hearing damage from shooting.



#### 9. NEVER CLIMB A TREE, FENCE OR OBSTRUCTION WITH A LOADED FIREARM.

Open and empty the chamber of your firearm and engage the manual safety catch before climbing or descending a tree or before climbing a fence or jumping over a ditch or other obstruction. Never pull or push a loaded firearm toward yourself or another person. Always unload the firearm, visually and physically check to see that the magazine, loading mechanism and chamber are unloaded and that the bolt is open before handing the firearm to another person. Never take a firearm from another person unless it is unloaded, visually and physically checked to confirm it is unloaded, and the action is open.



#### 10. AVOID ALCOHOLIC BEVERAGES OR JUDGMENT/ REFLEX IMPAIRING MEDICATION WHEN SHOOTING.

Do not drink and shoot. If you take medication that can impair motor reactions or judgment, do not handle a firearm while you are under the influence of the medication.



#### 11. NEVER TRANSPORT A LOADED FIREARM.

Unload a firearm before putting it in a vehicle (chamber empty, magazine empty). Hunters and target shooters should load their firearm only at their destination, and only when they are ready to shoot. If you carry a firearm for self-pro-



tection, leaving the chamber unloaded can reduce the chance of an unintentional discharge.

#### 12. LEAD WARNING.

Discharging firearms in poorly ventilated areas, cleaning firearms, or handling ammunition may result in exposure to lead and other substances known to cause birth defects, reproductive harm, and other serious physical injury. Have adequate ventilation at all times. Wash hands thoroughly after exposure.

**WARNING:** it is YOUR responsibility to know and abide by Federal, State and Local laws governing the sale, transportation and use of firearms in your area.

**WARNING:** this firearm has the capability of taking your life or the life of someone else! Always be extremely careful with your firearm. An accident is almost always the result of not following basic firearm safety rules.

#### Especially for U.S. consumers:

For information about Firearm Safety Courses in your area, please visit the National Rifle Association's web site at [www.nra.org](http://www.nra.org).



The instructions provided as text and illustrations on page 4 refer to the model SuperNova.

Alternative versions of the model Nova are shown on page 22.



## Presentation

*Thank you for selecting the Pump Action Shotgun*

Designed by the Benelli Armi Center for Studies and Research and developed by experts based on rich technological experience of precision engineering, this new shotgun marks a significant step in the smooth bore pump-action shotgun sector.

The small number of parts, the mechanical and rational simplicity, the originality of the rotating head closure system, give the new Benelli shotguns high functional reliability, ease of use, simplicity of disassembly and maintenance and are defined as the most modern, precise, safe, fast and "elegant" available.

**NOTE:** make sure that your firearm is fitted with a magazine tube containing a number of cartridges permitted by legislation in the country where you intend to use it.

## Assembly Instructions (of packaged shotgun)

### Package contents (fig. 1):

- a) gun stock-receiver-bolt-forend sub-assembly
- b) barrel-breech sub-assembly

**WARNING:** please remember to remove the **plastic barrel sheath** before using the firearm (fig. 2).

### Assembly Procedure

Push the cross-bolt safety located on the trigger guard to the safety "on" position: **the red ring** indicating the firing position should **not be visible** (fig. 3).

Figure 3A "Fire" position - Safety button is moved in a way that **a red ring is visible**. Firearm is **ready to fire**.

Figure 3B "Safe" position - Safety button is moved in a way that **no ring is visible**. Firearm is **not ready to fire**.

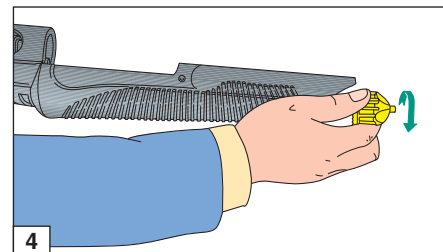
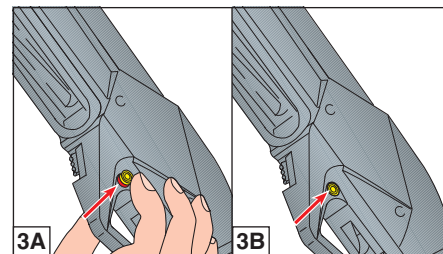
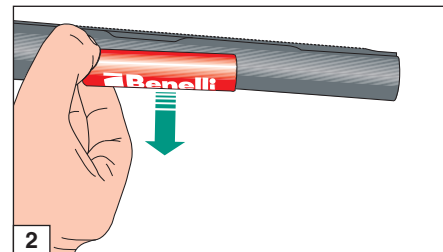
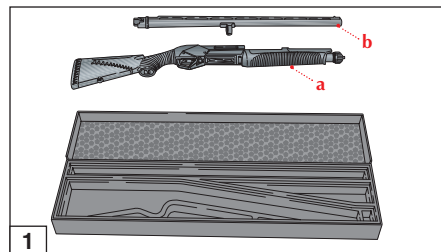



- 1) Unscrew magazine cap by turning it “counter clockwise” to the left (fig. 4).

*In the case of the short magazine tube **plus the extension** (two piece magazine), also remove the extension.*

**CAUTION:** when magazine extension is attached, carefully read the instructions entitled “Magazine tube extension” before continuing.

- 2) Hold the shotgun vertically, grasping the barrel-breech assembly and insert the barrel extension into the receiver. Be certain the barrel guide ring fits correctly over the magazine tube (fig. 5).

- 3) To make barrel insertion into the receiver easier, push **action release lever** up in the direction of the arrow to unlock the action (fig. 6); push the barrel extension fully into the receiver.

When properly installed, the ring on the outside of the barrel should rest firmly against the front of the receiver.

- 4) Screw the **magazine tube cap** onto the magazine tube until it is hand-tight (fig. 7).

### WARNING

When the pistol grip or telescopic stock is installed on the shotgun the stock must be tightened after the trigger guard assembly has been installed in the receiver. Completely tighten the pistol grip stock retaining nut or the telescopic stock grip retaining ring until it solidly contacts the shotgun receiver.

- 5) Ensure that the barrel is **completely** against the receiver (fig. 8). The barrel should be fixed and without movement when properly assembled and tightened.

### WARNING

Before performing any type of operation on the firearm, visually and physically check the firing chamber, carrier and magazine to verify that no ammunition is present. The magazine follower is orange in color with a raised circle in the center to help distinguish it from the base of a shot shell.

Make certain the firearm safety button is in the “safe” position. Be sure that the chamber and barrel are clear of all obstructions. Keep the muzzle of the firearm pointed in a safe direction at all times.

Check that the ammunition is the correct gauge and size for the firearm. Do not place finger or any other object inside trigger guard. Failure to follow these procedures could result in serious injury or death to yourself or others.

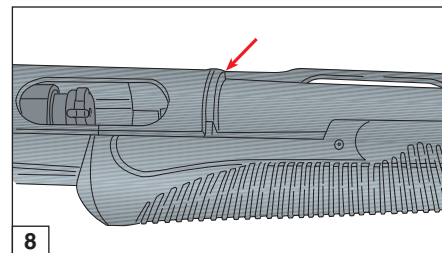
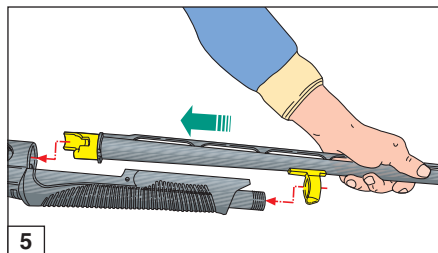
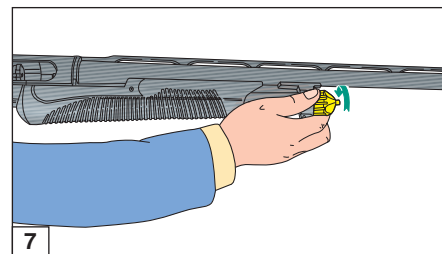
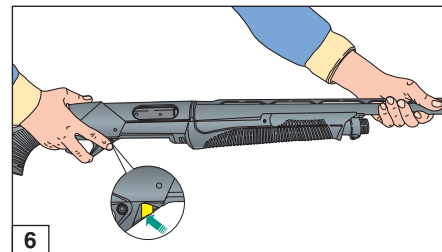



## Loading Procedures

### Indirect Method

The firearm safety must be in the “on” (safe) position and the hammer cocked to allow loading cartridges in the magazine. (The red dot on the action release lever must be visible).

- 1) With the action closed and the hammer cocked, turn over the firearm over so **bottom opening of the receiver is accessible** (fig. 9).
- 2) **Place a cartridge in the opening and insert it** into the magazine tube (figs. 9-10) until the cartridge stop lever automatically catches it and holds the cartridge in place. Repeat the operation until the magazine is completely loaded. The magazine can hold three 3" 1/2 (89 mm) cartridges or four 3" (76 mm) or 2" 3/4 (70 mm) cartridges.

The shotgun is not ready to fire until **a cartridge is loaded** into the chamber of the barrel using the following procedures:

- 3) Push the action release lever upward and bring the forend fully rearward (fig. 11) to **open the action**. A cartridge from the magazine tube will be released onto the carrier, lifted and put into the chamber as the action is closed by sliding the forend fully forward. The chamber is now loaded with a cartridge for firing.

### WARNING

The shotgun will fire if the safety is moved to the “fire” position and the trigger is pulled. Observe all safety rules.

An additional round can now be inserted into the magazine if desired.

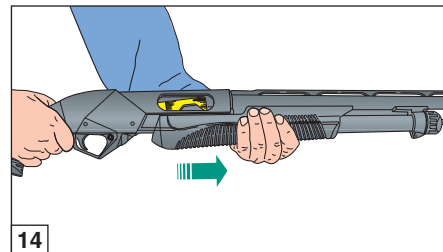
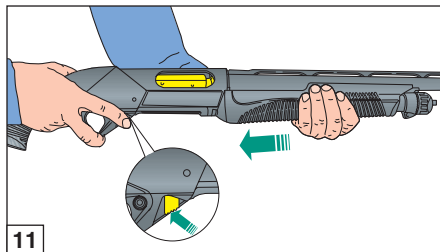
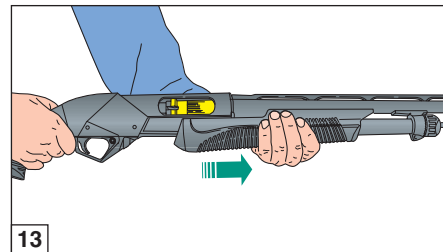
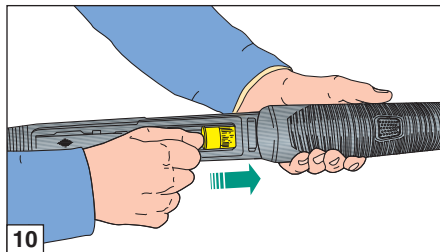
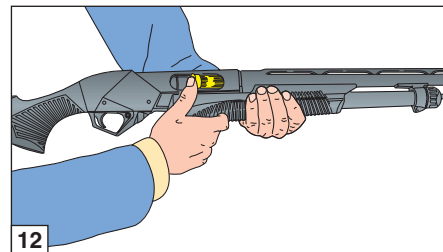
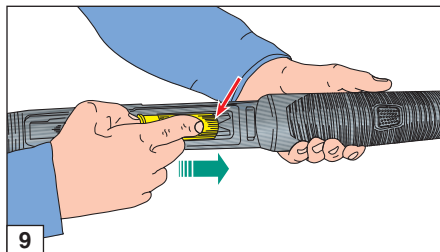





## Direct Method

- 1) Push the action release lever upward and bring **the forend** fully rearward (fig. 11) to open **the action** (fig. 14). **Place one cartridge through the ejection port into the receiver** (fig. 12) and **close the action by moving the forend forward** (fig. 13). **The chamber is now loaded with a cartridge for firing.**
- 2) Turn over the firearm over so **bottom opening of the receiver is accessible** (fig. 9).
- 3) **Place a cartridge in the opening and insert it** into the magazine tube (figs. 9-10) until the cartridge stop lever automatically catches it and holds the cartridge in place. Repeat the operation until the magazine is completely loaded. The magazine can hold three 3" 1/2 (89 mm) cartridges or four 2" 3/4 (70 mm) cartridges. To comply with federal and or local laws and regulations currently in effect, the shell capacity of the magazine should be reduced with the appropriate magazine limiting device.

## Firing the Shotgun

### WARNING

Observe all safety practices at the beginning of this manual.

- 1) Move the safety button **to the "fire" position.**
- 2) **Place** your finger on the trigger and pull it rearward to fire the gun.
- 3) The action will **unlock automatically** after firing.
- 4) Pulling the forearm **fully rearward will extract**

**and eject** the fired round **and release** a round from the magazine onto the carrier.

- 5) Moving the forearm fully forward **will chamber** the next round for firing.
- 6) The trigger **must be released** and allowed to re-set before the next round can be fired.
- 7) Pulling the trigger will fire the chambered round, and the cycle can be repeated until all rounds loaded in the shotgun have been fired.
- 8) After Firing: **put the safety** in the "on" (safe) position, **open the action** by sliding the forearm fully rearward, visually and physically **check chamber, carrier and magazine** to be sure the firearm is **completely unloaded.**

## Cartridge Replacement - Magazine Stop Button

(Perform this operation with the safety "on"- see Firearm Warnings - and the muzzle pointing in a safe direction). During these phases, always keep fingers away from the trigger.

To remove an unfired cartridge from the chamber **without** releasing a round from the magazine, proceed as follows:

- 1) Hold the firearm securely with buttstock against hip, depress **the action release lever** and slide the forearm rearward about 2 inches. The magazine shell stop button on the underside of the forend can now be activated by pushing it inward until it stops. Pull the forend rearward to open the action until the loaded cartridge is extracted from the chamber and ejected from the firearm (fig. 15); a cartridge

**will not** be released from the magazine.

- 2) Insert the desired cartridge into the open action of the receiver through the ejection port (fig. 16). **Close** the action. The firearm is now loaded and ready to be fired when the safety is moved to the "off" or "fire" position.



### WARNING

The mag stop button re-sets when the forearm is moved fully forward and a round will be released from the magazine on to the carrier the next time the forearm is moved fully rearward.

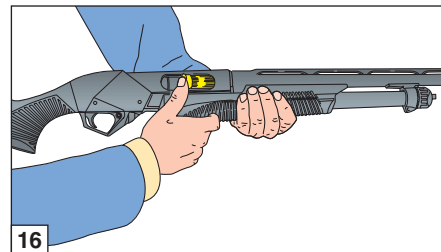
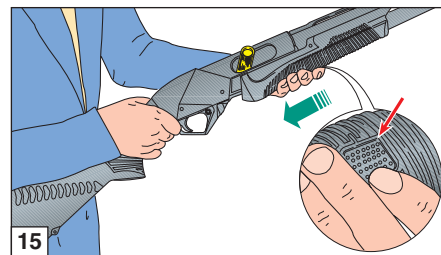



## Unloading the Firearm

Perform this operation with the safety “on”- see Firearm warnings - and the muzzle pointed in a safe direction. During these phases, always keep fingers away from the trigger.

### A) Manual Unloading

To unload the shotgun, do the following:

- 1) Move the safety button to the “on” (“safe”) position. Depress the action release locking lever (fig. 17), pull the forearm rearward about 2 inches and fully depress the Mag Stop button on the forend.
- 2) Rotate the shotgun to the right so the ejection port is facing downward and cup your hand under the port to catch the round extracted from the chamber as you move the forend fully rearward.

### WARNING

After removing the round, visually check the inside of the receiver to verify that no ammunition is present before closing the action fully on an empty chamber.

- 3) Rotate the shotgun so the loading port is facing upward.
- 4) Push the carrier down into the receiver to expose the opening in the end of the magazine tube.
- 5) Slide your thumb or finger along the right inside wall of the receiver until it contacts the base of the shell in the magazine tube and the cartridge stop lever.

**CAUTION:** rounds in the magazine are under spring pressure.

- 6) Depressing the cartridge stop lever by pushing it outward (to the right) will release one round from the magazine (fig. 17). Repeat this procedure until all rounds are removed and the orange follower is visible.
- 7) Depress the action release lever, open the action fully, and re-check the chamber, carrier and magazine visually and physically to be certain the firearm is completely unloaded.

### B) Using the pump action function to unload

#### WARNING

Make absolutely certain the safety is pushed fully to the right and it is in the “ON” position. No red ring is visible. Keep the muzzle pointed in a safe direction at all times. Keep fingers or other objects outside the trigger guard.

- 1) Depress the action release locking lever and keep it depressed. Sliding the forend fully rearward will extract the chambered round and eject it through the ejection port. It will also release a round from the magazine on to the carrier.
- 2) Sliding the forearm full forward will chamber the round resting on the carrier.
- 3) Repeat this cycle until all the cartridges from the magazine have been released and ejected.
- 4) Open the action and re-check the chamber, carrier and magazine visually and physically to be sure the firearm is completely unloaded.

**CAUTION:** be certain that the ejected rounds do not land on a hard surface. Wipe rounds clean before loading them into the firearm.

## Troubleshooting

Before performing any type of operation on any shotgun always ensure that the chamber, carrier and magazine are completely empty. Be sure the safety is in the “on” position and the muzzle is pointed in a safe direction.

(Carefully read the loading and unloading instructions of the firearm).

### Shotgun doesn't fire.

#### WARNING

Should a misfire occur, keep the muzzle pointed in a safe direction for one minute prior to taking any further action.

- 1) Check the safety: if it is on, push the button to the firing side (fig. 3A).
- 2) Open action to be sure a cartridge was loaded. Check to be sure there is a cartridge in the chamber. If necessary insert a cartridge, following the loading instruction.

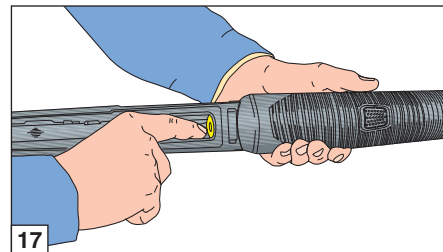



- 3) When assembling the firearm, be sure that the **magazine cap is tightly screwed to the barrel**, so that the barrel is completely **attached** to the receiver (figs. 7-8).
- 4) When a firearm does not function properly, make certain it is unloaded and the safety placed in the "on" position. Contact the Benelli USA customer service department for assistance (*for USA market only*).

## Ammunition to use

Correct functioning of the shotgun is only guaranteed with cartridges of a maximum length of **58 mm** (2" 3/4 - 70 mm chamber), **66 mm** (3" - 76 mm chamber) or **78 mm** (3" 1/2 - 89 mm chamber). The shotgun accepts cartridges with rolled turnover or crimped closures, and with lead or steel shot.

Benelli recommends use of shot loaded ammunition for ribbed barrels and balls for slug barrels. This is not mandatory but will ensure top-notch performance.

Chokes marked \* (**full**) and \*\* (**Imp. Modified**) are **not recommended** for use with steel shot.

### WARNING

**Never use cartridges longer than the firing chamber!**

**Ignoring this rule will result in serious consequences both to the firearm and the user.**  
Every Benelli shotgun undergoes a 1370 bar pressure test at the Banco Nazionale di Prova di Gardone Valtrompia located in Brescia.

## Maintenance

**WARNING:** before beginning these procedures, move the safety to the "on" ("safe") position, open the action, visually and physically check chamber, carrier and magazine to be sure the firearm is completely unloaded. **Keep the firearm pointed in a safe direction at all times. Failure to do so may result in serious injury or death to you or others. Wear eye protection to avoid potential injury from small parts or cleaning agents.**

### Barrel

Remove the barrel when cleaning the bore so the cleaning rod can be inserted from the chamber end. Leave the choke tube in the bore to avoid contaminating the threads with powder residue. Clean with a commercially available gun solvent. Put a light coat of gun oil in the bore and on the outside metal surfaces to protect against corrosion.

### Trigger Assembly

Clean as a unit with gun solvent. Blow dry with compressed air if available. Lightly oil to prevent corrosion. Wipe dry.

**NOTE:** do not use excessive amounts of oil that will hold dirt and other contaminants.

### Bolt Assembly

Disassemble as described previously. Clean with solvent, lightly oil, and wipe dry.

**NOTE:** avoid excessive oil in firing pin hole. Use special lubricant designed for sub-zero use

when hunting in extreme cold conditions.

For a proper maintenance of your firearm, **use Benelli cleaning kit** (*not supplied*).

**Benelli oil is recommended** for lubricating and protecting mechanical parts (receiver, bolt and barrel) (fig. 18).

Benelli recommends use of specific products for cleaning other parts (wooden, technopolymer and camouflage or painted stock and fore-end). Avoid that parts get in contact **with oils containing solvents or chemical substances in general, which could alter or damage their surfaces.**

## Disassembly of the Firearm

(Necessary for maintenance and cleaning)

### WARNING

**Before performing any type of operation on the shotgun always ensure that the chamber, carrier and magazine are completely empty.**

(Carefully read the unloading instructions of the firearm).

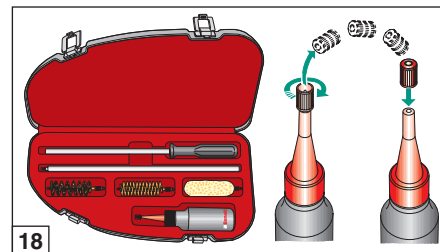



## Disassembly Procedure

### Barrel

- 1) To remove the barrel, **unscrew the magazine tube cap** (fig. 19); by turning it counter-clockwise.
- 2) Depress the action release locking lever and pull the forend **partially rearward** to release the bolt from the barrel extension.
- 3) Holding **the barrel, pull it forward along the magazine tube until the ring clears the tube**. Lift the barrel slightly up and away from the magazine tube and slide it forward (fig. 20).

### Trigger Assembly Group

- 4) Using the peg on the end of the magazine tube cap, start pushing the trigger guard **pins** out from the right side (ejection port side) of the receiver. Using the open inside edge of the magazine tube cap, **hook the heads** of the pins now protruding from the left side of the receiver. Pull them completely out of the receiver (figs. 21-22).

**NOTE:** the larger of the two pins fits the front hole and the smaller, the rear.

- 5) Rotate the shotgun so the trigger guard is facing upward.
- 6) Remove the trigger guard assembly **by pulling** the trigger guard upward and away from the bottom of the receiver (fig. 23).

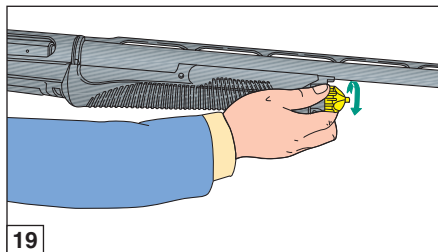

19

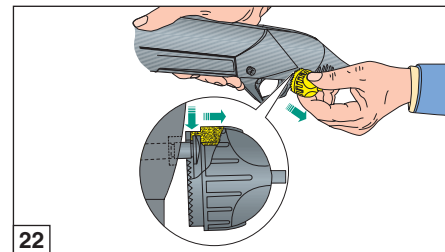

22

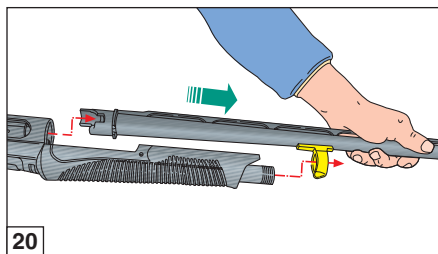

20

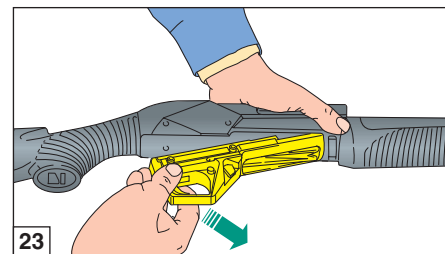

23

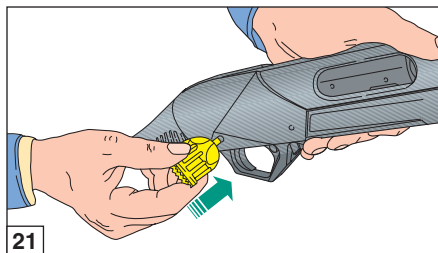

21

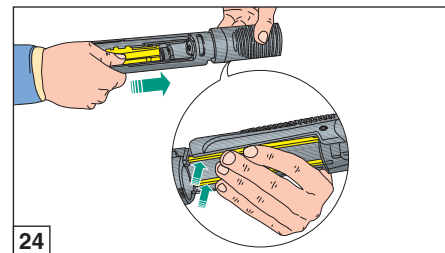

24



### WARNING

When the pistol grip or telescopic stock is installed on the shotgun the stock must be loosened before the trigger guard assembly can be removed from the receiver. To do this partially unscrew the pistol grip stock retaining nut or the telescopic grip retaining ring nut; thus making it possible to detach the pistol grip stock or the telescopic stock grip from the receiver to provide the space necessary for removing the trigger guard assembly.

- 7) Turn the shotgun over so the receiver opening is facing down and slide the forearm fully rearward. Insert your thumb inside the receiver from the bottom and **push the bolt** upward against the top inside of the receiver to separate it from the action bars (fig. 24).
- 8) **Compress** the bolt assembly by squeezing the bolt head and body together with thumb and index finger and pull the bolt up and out of the receiver (figs. 25-26).
- 9) Remove the forearm assembly **by sliding** it forward and completely off the magazine tube (fig. 27).

### Firing Pin Removal

**CAUTION:** the firing pin is under spring pressure from the firing pin return spring when assembled in the bolt.

To prevent loss or possible eye injury, depress and hold the rear of the firing pin with your thumb or finger.

Pull the stop pivot pin (with rubber "O" ring)

out from the bolt, and gradually release pressure on the firing pin until spring pressure is relieved. The firing pin and spring can now be completely removed from the rear of the bolt (figs. 28-29). Your shotgun is now disassembled for routine cleaning or maintenance.

### NOTE

Further disassembly of the trigger group assembly is not recommended unless you are a trained gunsmith.

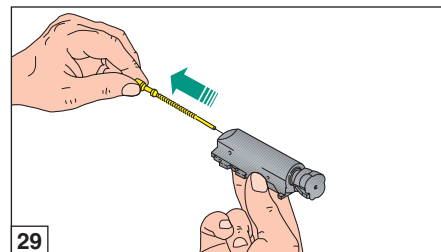
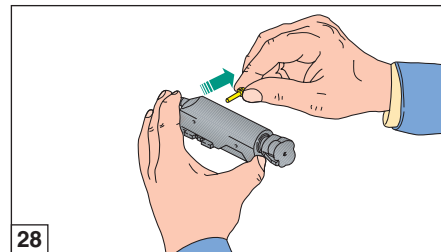
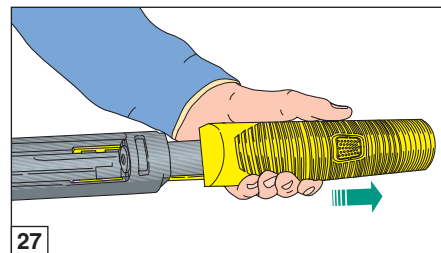
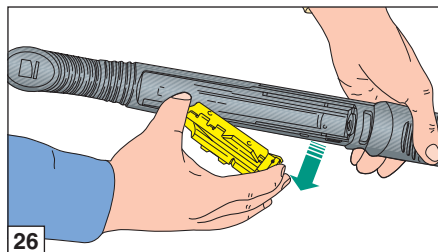
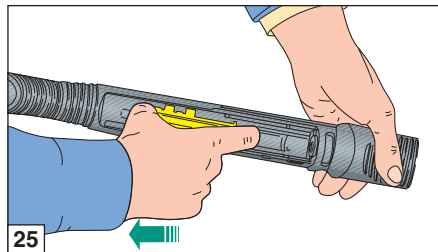



## Firearm Assembly

Follow the assembly instructions carefully **to ensure proper placement of all components**. Do not use excessive force. If components do not assemble easily, re-read instructions or call Benelli USA for assistance (*for USA market only*).

- 1) Slide the firing pin spring over the front of the firing pin and insert the assembly into the rear of the bolt.
- 2) Depress the end of the firing pin with your thumb and hold it in that position **while inserting cross pin** which retains it in the bolt. Push the cross pin in fully against the side of the bolt. The resistance of the "O" ring is designed to prevent the pin from working loose during normal operation.

## CHECK

When properly assembled, the bolt head and firing pin should both **be free to move** into the bolt body and should spring back (outward) when released.

- 3) With the flat side of the bolt assembly facing your hand, compress and hold the bolt head against the bolt body by squeezing the assembly between your thumb and forefinger.
- 4) Turn the gun with the open underside of the receiver facing upward.
- 5) Position the bolt head opposite the middle of the ejection port, insert the assembly through the bottom of the receiver.

Holding the bolt assembly at a 45° angle to the receiver and inserting the bolt head first, will simplify this procedure (fig. 30).

- 6) Tilt the firearm upward and allow the bolt to slide to the rear of the receiver (fig. 31).
- 7) Slide the forend assembly over the magazine tube and guide each action bar into the corresponding slot in the front of the receiver (fig. 32).
- 8) **Slowly** slide the forearm toward the receiver. As the action bars move rearward inside the receiver, they may stop when they contact the front of the bolt assembly. **Do not force.** Lift each action bar upward slightly so it can slide over the bolt assembly (figs. 33-34).
- 9) Continue moving the forend rearward slowly until the ends of the action bar stop at the rear of the receiver.
- 10) With the bolt and action bars fully to the rear, move the forearm forward about 1/4 inch so that the notches in the action bars **line up properly** with the corresponding surfaces in the bolt assembly. Push each action bar downward to be certain they are positioned properly.
- 11) The bolt, action bars, and forend should now be locked together and move smoothly.
- 12) **Slowly** slide the forend fully forward until the bolt stops on the front of the receiver.
- 13) Push downward slightly on each action bar once more to be certain **they are properly** engaged with the bolt.

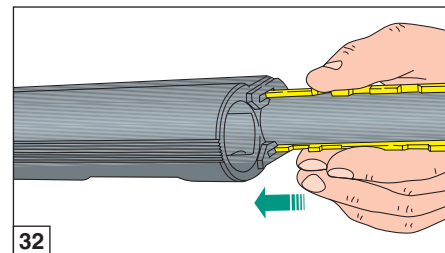
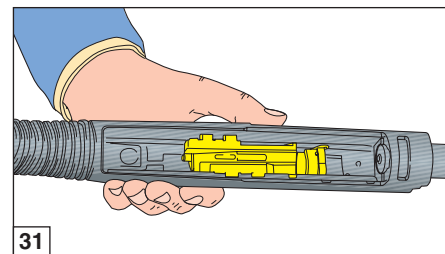
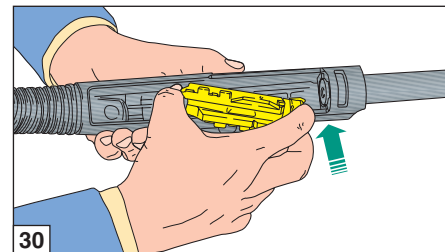





If they are not, the trigger group will not seat properly (fig. 35).

- 14) Be certain the hammer is **fully cocked** in the trigger assembly.
- 15) Insert the front end of the trigger guard in the front of the receiver opening, and then swing the rear portion downward until the assembly locks into position.

**Do not force** (figs. 36-37).

- 16) Insert the trigger group pins (longer pin in front) through the receiver until the large heads are flush with the sides (fig. 38).

## Function Testing

Whenever the firearm is reassembled, a **brief function test** should be conducted before firing to insure that all parts and safeties are assembled correctly and functioning properly.

### WARNING

**Visually and physically check the chamber, carrier and magazine to be sure no ammunition is present. Keep the firearm pointed in a safe direction at all times.**

- 1) **Put the safety in the "on" ("safe") position** and close the action by moving the forearm fully forward. The action should move smoothly with binding.
- 2) Without activating the action release lever, pull rearward on the forend. The action should remain locked and should not open.

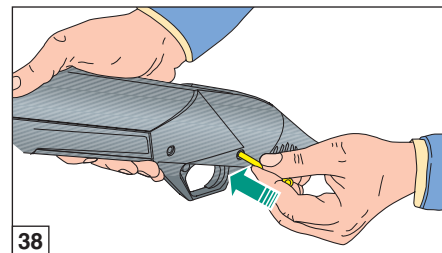
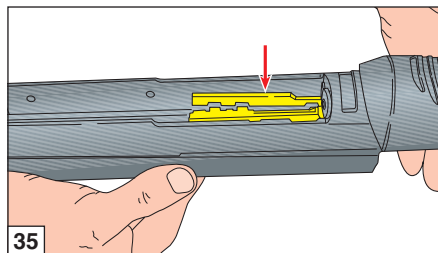
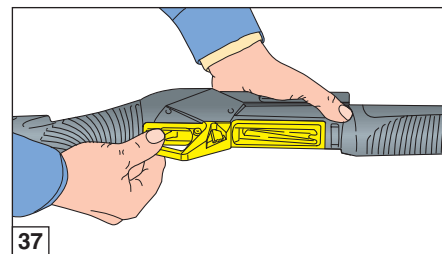
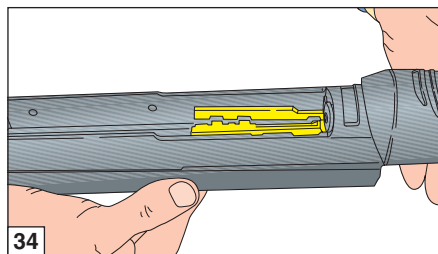
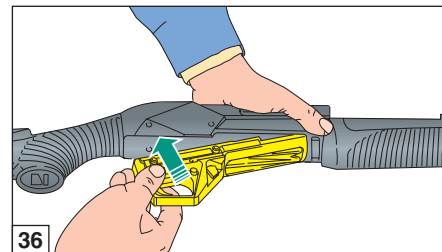
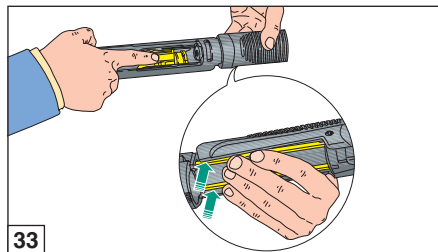

- 3) Push the action release lever. The action should unlock.
- 4) Move the forearm fully rearward and then fully forward. It should **move freely** and lock again in the closed position.
- 5) **With the safety in the “on” (“safe”) position**, pull the trigger. The hammer **should not** fall.
- 6) Move the safety button to the **fire position** (red ring visible) and pull the trigger. The hammer should fall and the action should unlock.
- 7) Cycle the action again by moving the forearm fully rearward and then fully forward.

**Check to be sure** the bolt locks properly. Pull the trigger. The hammer should fall. Open the action fully.

### WARNING

Follow all safety instructions regarding placement of the safety in the “on” position and keep the muzzle pointed in a safe direction.

## ACCESSORIES AND ADJUSTMENTS

### Drop and cast adjustment (where expected)

**Before beginning any operation on your shotgun, always make sure that chamber and magazine have been completely emptied!** (Carefully read loading and unloading instructions).

DROP CHANGE SCHEDULE			
Cast shim (plastic)	Stock locking plate (steel)	Drop shim (plastic)	Drop value at heel (mm)
Reference letter	Reference letter	Reference letter	
DX	Z DX	Z	50 ± 1 DX
SX	Z SX		50 ± 1 SX
DX	A DX	A	55 ± 1 DX
SX	A SX		55 ± 1 SX
DX	B DX	B	60 ± 1 DX
SX	B SX		60 ± 1 SX
DX	C DX	C	65 ± 1 DX
SX	C SX		65 ± 1 SX

**Matching instructions:** the drop change shims and stock locking plates in the kit are identified by letters. To ensure a correct drop, **always** use plates and shims **with the same letter**, e.g.: **C - CDX** – for a 65-RH drop or **C - CSX** – for a 65-LH drop.

DX = Right hand

SX = Left hand

The shotgun is supplied with a “**drop change kit**” (fig. 39) which enables you to adjust the original drop the shotgun is supplied with. The kit consists of **one stock locking plate** (in steel), plus **drop change shims three** (plastic).

The kit enables you to obtain four different drop patterns (as specified in the following table) and two different deflections (right hand or left hand).

Each unit **is marked with the corresponding drop and cast letter**.

Determine if your stock drop fits you perfectly, or whether it is either too high or too low for you.

If it is too low, you need to select the previous adjustment set in alphabetical order (e.g. if the shim supplied on the shotgun is marked with a “C”, you must select the “B”, together with the corresponding stock locking plate).

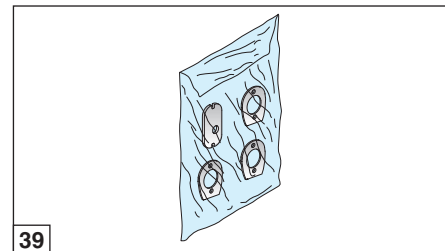





Replacement procedure is very simple (fig. 40):

- 1) Grasp the bottom of **the buttpad "1"** and pull upwards (figs. 41-42).
- 2) Unscrew **the stock retaining nut "2"** (using a 13 mm hexagon wrench).
- 3) **Take the nut "2", the lock washer "3", the stock locking plate "4", the stock "5", the cast shim "6" and the drop shim "7"** out of the recoil spring tube.

**WARNING:** the stock spacer "8" will remain inside the stock; it is held in place by the stock's rear shim.

- 4) Assemble **the drop shim "7"** that you have selected onto the recoil spring tube with the **stamped letter** facing toward the stock.
- 5) Reassemble the selected **cast shim "6"** with the stamped letter (D.X. or S.X.) facing toward the stock.
- 6) Point the barrel towards the floor and fit on **the stock** and keep it in position while you place the corresponding retaining **plate "4"** in the stock shim, with the stamped letter facing toward the butt plate.
- 7) Fit **the lock washer "3"** and nut **"2"** back onto the recoil spring tube and **tighten firmly**.
- 8) To replace **the buttpad "1"**, push it firmly against the buttstock to replace it to its original position (fig. 43).

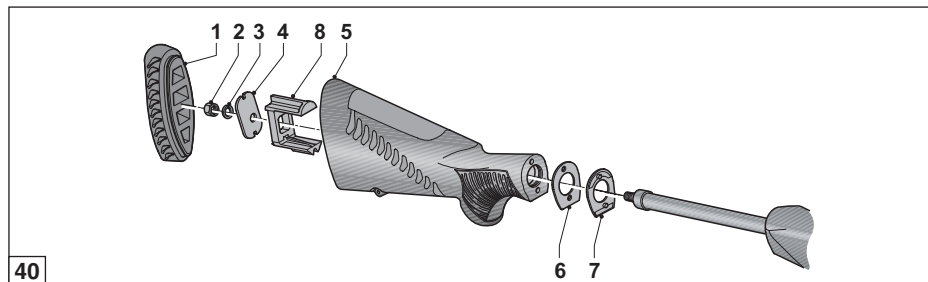

**WARNING:** always use **drop shims "7"**, **cast shims "6"** and **stock locking plates "4"** with the corresponding lettering, e.g. C - CDX - DX or C - CSX - SX. The use of component parts with different letters may cause permanent deformation of the recoil spring tube with as a result, bolt sliding problems.

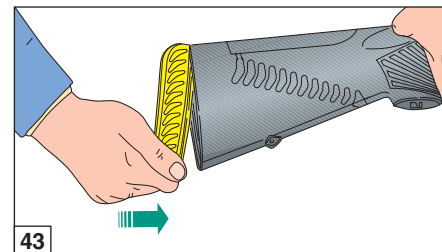
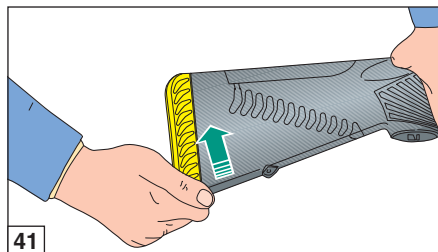
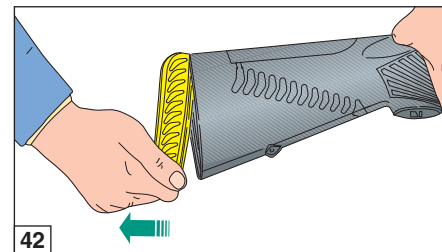



**WARNING:** once stock has been replaced, make sure it is correctly retained to the receiver.

After having fired the first few rounds, repeat check and if necessary, fix the stock again by removing the butt plate again and tightening the nut again by using appropriate wrench.

Having altered the stock drop of the shotgun, you have also obviously altered the firing position as well: it **is therefore** necessary that you first practice shooting some clay targets in order to make sure that the firing position is suitable to your size and shooting style.

**NOTE:** due to the softness of the material of which the Benelli gel recoil pad is constructed, the pad is more susceptible to rough use, including excessive abrasion and exposure to sharp edges. Such exposure can lead to superficial surface damage. Superficial surface damage will not result in a loss of the shock absorbing performance of the gel pad.

## Telescoping stock

### Adjusting

- 1) Press **the lock button** (fig. 44) and move the stock back as far out as it will go (fig. 45).
- 2) Press **the lock button** using more force to remove the stock completely (fig. 46).

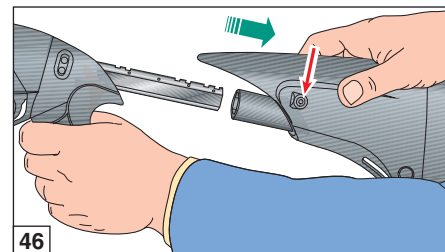
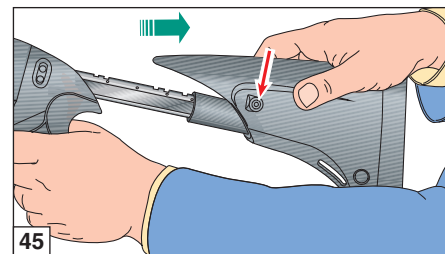
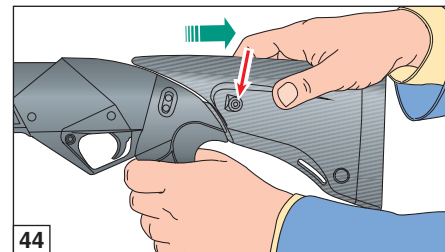

## Short tube limiter

### Increasing Magazine Capacity

Your new shotgun is shipped from the factory with a plastic rod in the magazine that limits the magazine capacity to two cartridges to comply with federal migratory game regulations.



Magazine capacity can be increased to four 2 3/4 inch or 3 inch cartridges by removing the plug as follows (fig. 47):

- 1) Unscrew and remove the magazine cap by turning it counter clockwise.
- 2) Remove the barrel to prevent accidental scratching of the finish.
- 3) Insert and hold a screwdriver blade into the opening in the magazine tube to capture the spring and retainer when they are released.

**CAUTION:** the magazine spring and retainer are under pressure inside the magazine tube and will fly out with considerable force. Use caution to avoid injury.

- 4) Using a pair of snap ring or needle-nose pliers, squeeze the retaining ring together. The spring pressure will allow it to come out of the tube and slide up the screwdriver shaft.
- 5) Remove the retainer and spring from the magazine tube.
- 6) Point the magazine tube downward so the limiter will slide out. Remove the limiter only. The cup shaped plastic follower must remain in the magazine tube (closed end facing the receiver) for proper feeding.
- 7) Insert the spring into the tube.
- 8) Slide the retaining ring onto the screwdriver shaft with the cupped side facing away from the handle.

- 9) Insert the screw driver blade into the spring and slowly compress it into the magazine tube.
- 10) Push the retainer against the mouth of the magazine tube.  
Tap the end of the screwdriver handle to push the retainer into the magazine tube until it is flush with the end of the tube.
- 11) Re-install the barrel.
- 12) Screw on the magazine cap and hand-tighten.
- 13) Check to be sure that the barrel is fully seated against the receiver.

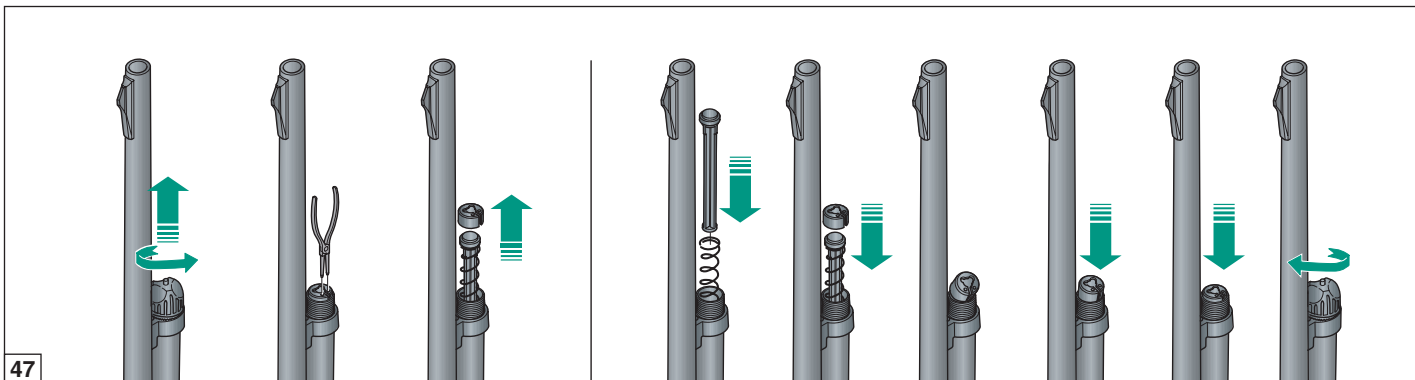



## Magazine extension tube

Models can be fitted with a magazine extension tube to increase the capacity up to seven cartridges 3" length, depending on the magazine extension installed (capacity also changes depending on the length of cartridges used).

*Assembly instruction: see page 17.*

### Extension kit (A)

The "+1 round" Magazine Extension includes: a magazine cap extension with mounting holes, a magazine extension tube, a plug for the magazine extension and a long magazine spring (fig. 48).

### Extension kit (B)

The "+2 rounds" or "+3 rounds" Magazine Extensions include: a magazine cap extension with mounting holes, a magazine extension tube, a plug for the magazine extension, a long magazine spring, and a set of clamps for attaching the extension to the barrel (fig. 49).

### WARNING

**Before performing any type of operation on the shotgun always ensure that the chamber, carrier and magazine are completely empty. Carefully read the loading and unloading instructions of the firearm.**

### NOTE

- Remove the magazine spring **holding ring** from the firearm and replace it with the **magazine tube extension** for it when mounting one of the above described kits.
- Use the long magazine spring **when mounting the magazine extension tube.**

**WARNING:** To use **magazine tube extensions** that **protrude** from the barrel's muzzle, it is necessary to make sure to use cartridges with such an energy **to complete the combustion inside the barrel**, to prevent firing heat and gas from damaging the components.

### ATTENTION

*If the shotgun utilizes a two-piece magazine (short magazine tube plus extension), during the disassembly of the magazine cap, also remove the tube extension.*

### WARNING

**Magazine tube spring is contained under pressure and must be handled carefully upon removal or replacement.**

**Use caution to avoid the magazine spring flying from the tube at a high speed.**

**Use eye protection during this operation.**

**If the spring were to come off at a high speed it could hit the eye or other part of the face, causing serious injuries.**

**Use the same care when remounting.**

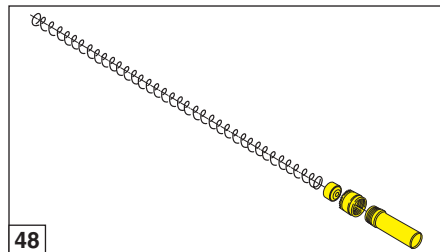

48

## Long tube limiter

**Before starting any operation on your shotgun, make sure that the chamber and the magazine are unloaded!**

(Carefully read the instructions on gun loading and unloading).

### WARNING

**The following operations must be carried out carefully in order to prevent the magazine spring from escaping at high speed.**

**When carrying these operations out, always wear eye protection.**

**If the magazine spring escapes at high velocity severe eye injury or other injuries with serious consequences can occur.**

**The same care must be taken during assembly.**

In compliance to legislation in force, long tube versions are equipped with a barrel limiter for the limitation of the magazine capacity.

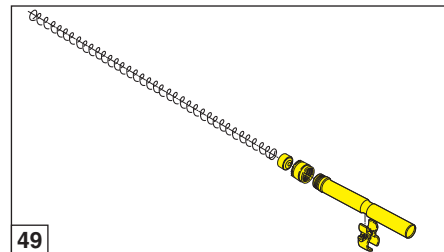

49



To remove the limiter proceed as follows:

- 1) **With the gun unloaded**, point the barrel upwards. Using the index finger of your hand, remove the **limiter retaining** from the magazine tube (fig. 50).

To facilitate removal, rest your right thumb on the magazine tube and **turn** the retaining ring until one of the tabs passes the magazine tube spigot (fig. 51).

- 2) **Hold** the limiter and retaining ring and allow them to be forced out of the magazine by the magazine spring.
- 3) **Completely** remove limiter and retaining ring from magazine.

To install the limiter, proceed as follows:

- 1) **With the gun unloaded**, point barrel upwards and insert the limiter into the appropriate fitting hole (fig. 52).

- 2) Take the limiter retaining ring in your hand and position it on the limiter. Ring should be **positioned at a slight angle** (fig. 53).

- 3) **Push** the limiter into the magazine tube, ensuring that the retaining ring enters properly (fig. 54).

*Keeping the ring positioned at a slight angle will **enable** it to slip into the magazine tube entirely, even though it is wider than the tube bore.*

- 4) **Reduce** finger pressure until the limiter is tight against the tube spigot (fig. 55).

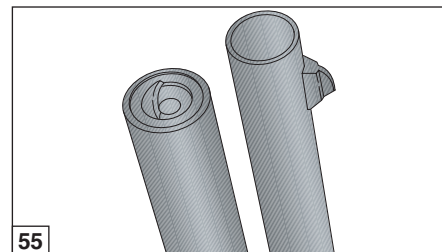
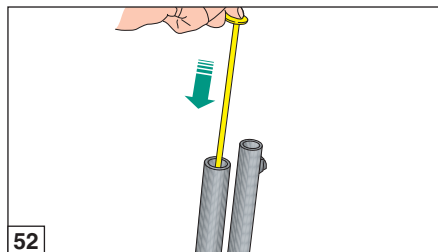
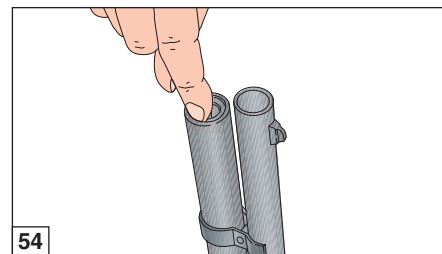
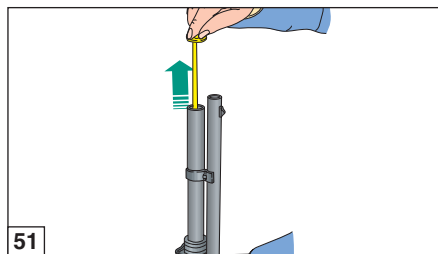
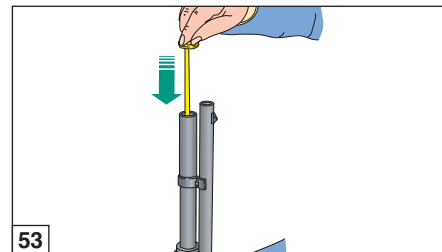
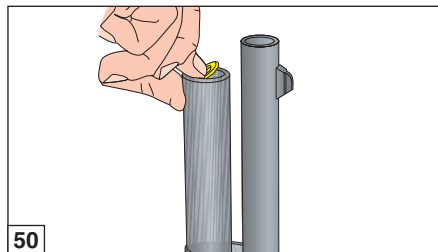



## Internal Choke

The barrel is equipped with interchangeable internal chokes.

Before leaving the firearm unused for an extended period, **it is advisable to remove**, clean and lubricate the internal choke and barrel.

**Before performing any type of operation on the shotgun always ensure that the chamber, carrier and magazine are completely empty.**

(Carefully read the loading and unloading instructions of the firearms).

**WARNING:** before using the shotgun, make sure that the barrel has a choke correctly installed.

**WARNING:** the internal choke correctly mounted must not stick out of the barrel's muzzle. Use only the Benelli internal choke length which correctly fits the barrel.

To change or clean the internal choke, do the following:

- 1) Unscrew the internal choke using the **special tool** supplied with the firearm, and completely remove it from its position in the barrel (fig. 56).
- 2) If the threaded seat of the choke on the barrel is dirty, **clean it**.
- 3) Lubricate the threads of the choke tube, to be installed in the barrel, with a **good quality** choke tube lubricant.
- 4) Replace the type of choke desired in its place in the barrel, being careful to insert the threaded end of the choke **inside the barrel** before starting to screw it onto the threads of the barrel (fig. 57).

- 5) Complete the mounting of the choke by **screwing it in firmly**, using the toothed key (fig. 58).

**ATTENTION:** a correctly installed choke should not extend beyond the opening of the barrel.

**ATTENTION:** before using the firearm, ensure that the choke tube tool has been removed from the muzzle of the barrel.

Benelli choke tubes are marked for easy identification (fig. 59). Notches on the muzzle end of each tube allow for quick recognition, even when the choke tube is installed in the shotgun.

NOTCHES	CHOKE	SYMBOL	STEEL SHOT
I	Full	X	NO
II	Improved Modified	XX	NO
III	Modified	XXX	OK
IIII	Improved Cylinder	XXXX	OK
IIIII	Cylinder	XXXXX	OK

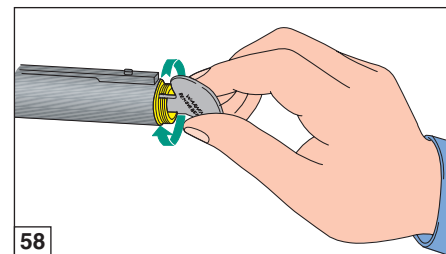
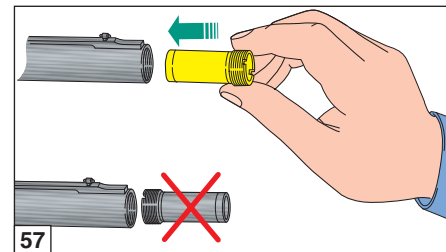
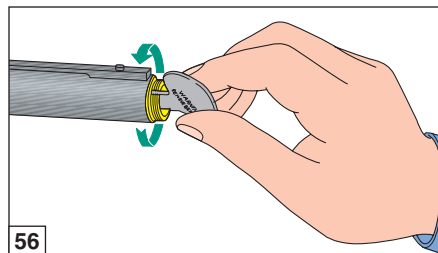

A Notches

B Symbol

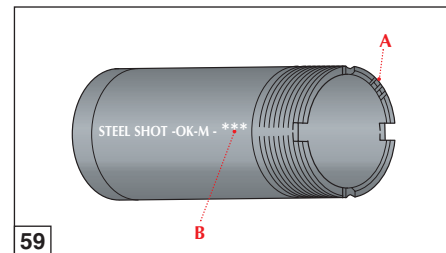



## Adjusting the back-sight

For the adjustment of the **back-sight** as illustrated in **figure 60**, proceed as follows:

- 1) Using the **wrench provided**, slacken the two sight screws.
- 2) Adjust the sight position as desired (move it to the left if you want the point of impact to move left or move it to the right if you want the point of impact to move right) and **fully tighten** the two screws.

Proceed as follows to carry out the **back-sight** adjustments as shown in **figures 61, 62, 63 and 64**:

### A - Lateral adjustment

By means of the **relative screw**, set the sight position as desired (move it to the left if you want the point of impact to move left or move it to the right if you want the point of impact to move right) by adjusting it according to the **graduated alignment notches**.

### B - Vertical adjustment

By means of the **relative screw**, set the sight position as desired (in the "up" anticlockwise direction if you want to raise the point of impact or in the opposite direction if you want the point of impact to be lower) by adjusting it according to the **graduated alignment notches**.

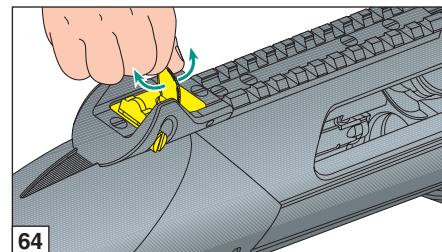
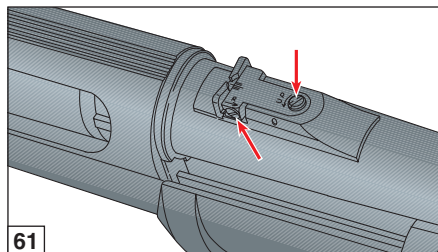
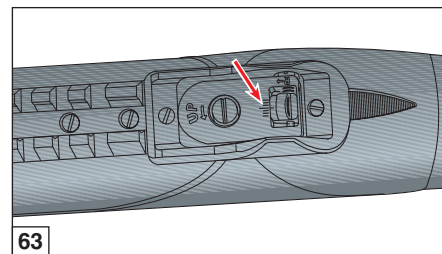
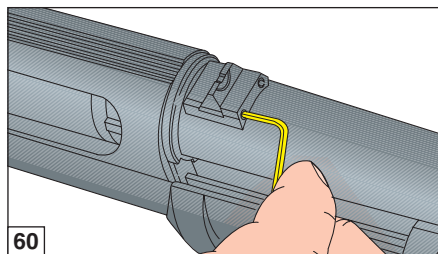
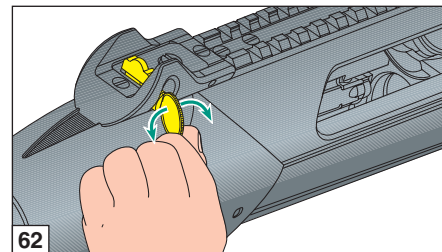





## NOVA model

### Ammunition to use

#### 12 gauge

Correct functioning of the shotgun is only guaranteed with cartridges of a maximum length of **58 mm** (2" 3/4 - 70 mm chamber), **66 mm** (3" - 76 mm chamber) or **78 mm** (3" 1/2 - 89 mm chamber).

#### 20 gauge

Correct functioning of the shotgun is only guaranteed with cartridges of a maximum length of **58 mm** (2" 3/4 - 70 mm chamber) or **66 mm** (3" - 76 mm chamber).

The shotgun accepts cartridges with rolled turnover or crimped closures, and with lead or steel shot.

### Magazine extension tube

#### 12 gauge extension kit

The **"+1 round"** Magazine Extension includes: a magazine cap extension with mounting holes, a magazine extension tube, a plug for the magazine extension and a long magazine spring.

#### 12 gauge and 20 gauge extension kit

The **"+2 rounds"** and **"+3 rounds"** (12 gauge only) Magazine Extensions include: a magazine cap extension with mounting holes, a magazine extension tube, a plug for the magazine extension, a long magazine spring, and a set of clamps for attaching the extension to the barrel.

**WARNING:** To use **magazine tube extensions** that **protrude** from the barrel's muzzle, it is necessary to make sure to use cartridges with such an energy **to complete the combustion inside the barrel**, to prevent firing heat and gas from damaging the components.

### Buttstock Cavity

#### WARNING:

**The compartment is not for the storage of live ammunition.**

A compartment is located in the hollow buttstock of the shotgun where a recoil reducer can be installed in the integrated assembly. The butt-pad is not attached nor glued, and can be removed without the use of any tool.

To reach the compartment:

- 1) Grasp the bottom of the buttpad and pull upwards (fig. 41-42).
- 2) To replace the buttpad, push it firmly against the buttstock to replace it to its original position (fig. 43).

### ACCESSORIES AND ADJUSTMENTS

#### Optional Recoil Reduction Device (12 gauge only)

#### WARNING:

**Follow all safety instructions regarding placement of the safety in the "on" position and keeping the muzzle pointed in a safe direction.**

To Install Optional Recoil Reduction Device:

- 1) Remove buttpad as earlier instructed.
- 2) Screw the Recoil Reduction Device inside the buttstock cavity (fig. 65).
- 3) Depress metal tab of retainer in circle and pull upward to remove it from the retainer slot (fig. 66A-66B).
- 4) Let spacer plug fall out of tube.
- 5) Insert choice of optional recoil reducer in tube.
- 6) Replace spacer plug and reinsert retainer tab.
- 7) Replace buttpad as earlier instructed.

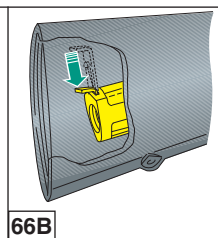
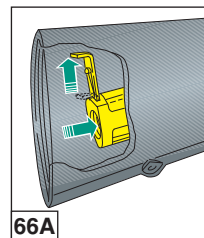
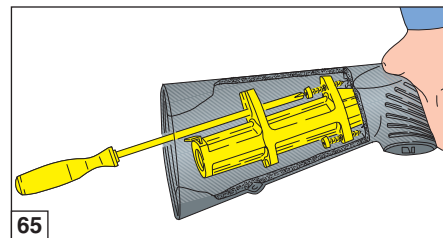





## Spare Parts Lists



To order spare parts you must specify the gauge, the model and the serial number of your shotgun.

Part numbers here listed refer to respective drawings.

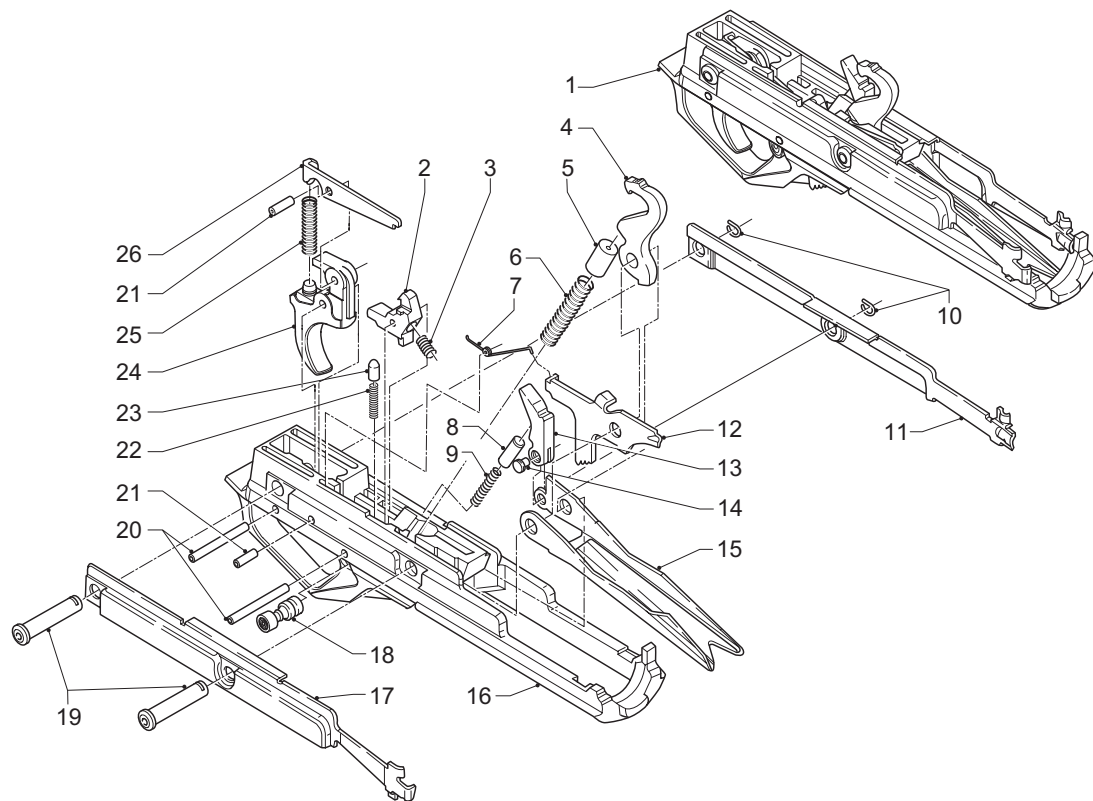



Pos. No.	Code SuperNova	Code Nova 12GA	Code Nova 20GA	Description
1	001S	001N	001T	Trigger guard assembly
2	217N	217N	217N	Disconnecter hammer
3	218N	218N	218N	Disconnecter hammer spring
4	002N	002N	002N	Hammer
5	003A	003A	003A	Hammer spring cap
6	004N	004N	004N	Hammer spring
7	220N	220N	220N	Breech bolt latch spring
8	221N	221N	221N	Bolt stop cap
9	021N	021N	021N	Carrier spring
10	018A	018A	018A	Trigger guard pin spring
11	214N	214N	214T	L.H. carrier latch
12	219N	219N	219T	Breech bolt latch
13	019N	019N	019T	Bolt stop tooth
14	020A	020A	020T	Bolt stop tooth pin
15	017N	017N	017T	Carrier
16	014S	014N	014T	Trigger guard
17	222N	222N	222T	R.H. carrier latch
18	013S	013N	013C	Hand safety button
19	016N	016N	016T	Trigger pin bush
20	010N	010N	010T	Trigger pin
21	216N	216N	216N	Disconnecter plunger
22	007A	007A	007A	Safety plunger spring
23	008A	008A	008A	Hand safety plunger
24	009S	009N	009N	Trigger

[illegible]

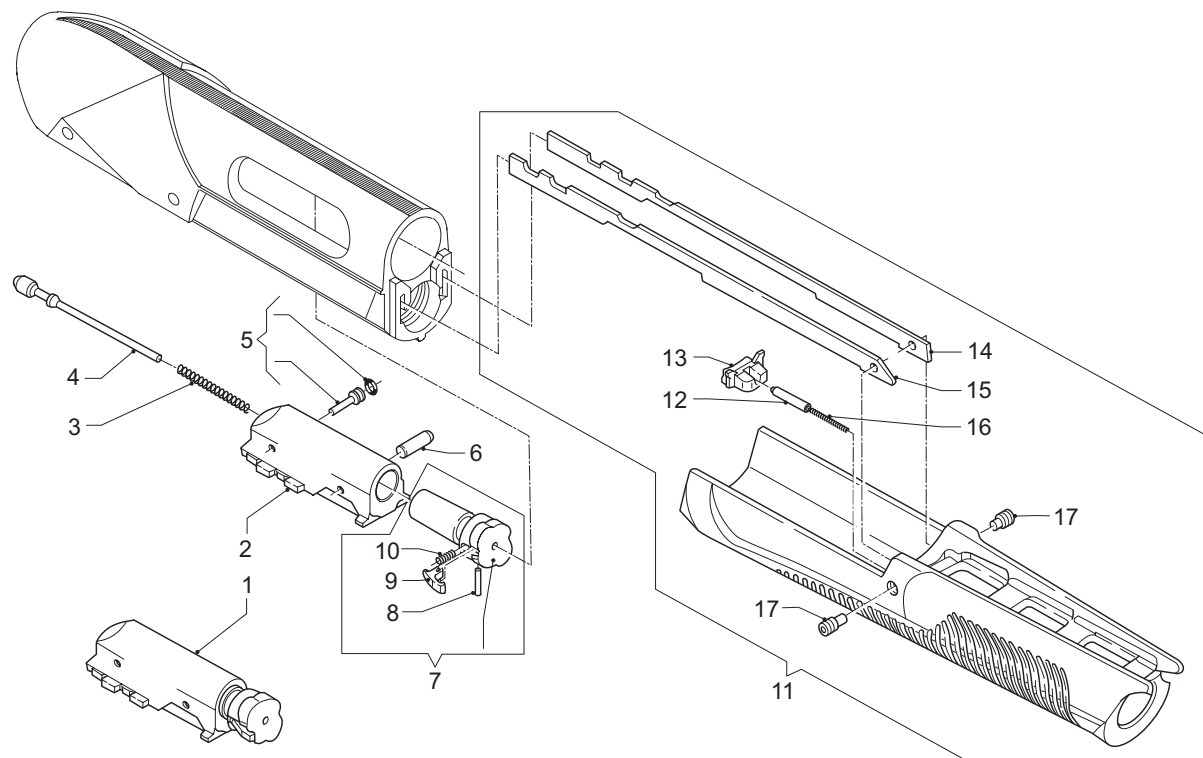



Pos. No.	Code SuperNova	Code Nova 12GA	Code Nova 20GA	Description
1	024N	024N	024T	Bolt assembly
2	026N	026N	026T	Bolt
3	037N	037N	037N	Firing pin spring
4	025N	025N	025N	Firing pin
5	028A	028A	028A	Retaining pin
6	031N	031N	031T	Locking head pin
7	165N	165N	165T	Locking head assembly
8	035A	035A	035A	Extractor pin
9	034A	034A	034A	Extractor
10	033J	033J	033J	Extractor spring
11	236N	236N	228T	Fore-end assembly
12	233N	233N	233N	Mag-Stop bush
13	232N	232N	232N	Mag-Stop button
14	223N	223N	223T	L.H. action bar
15	225N	225N	225T	R.H. action bar
16	234N	234N	234N	Mag-Stop spring
17	224N	224N	224N	Action bar retaining pin

Pos. No.	Code SuperNova	Code Nova 12GA	Code Nova 20GA	Description



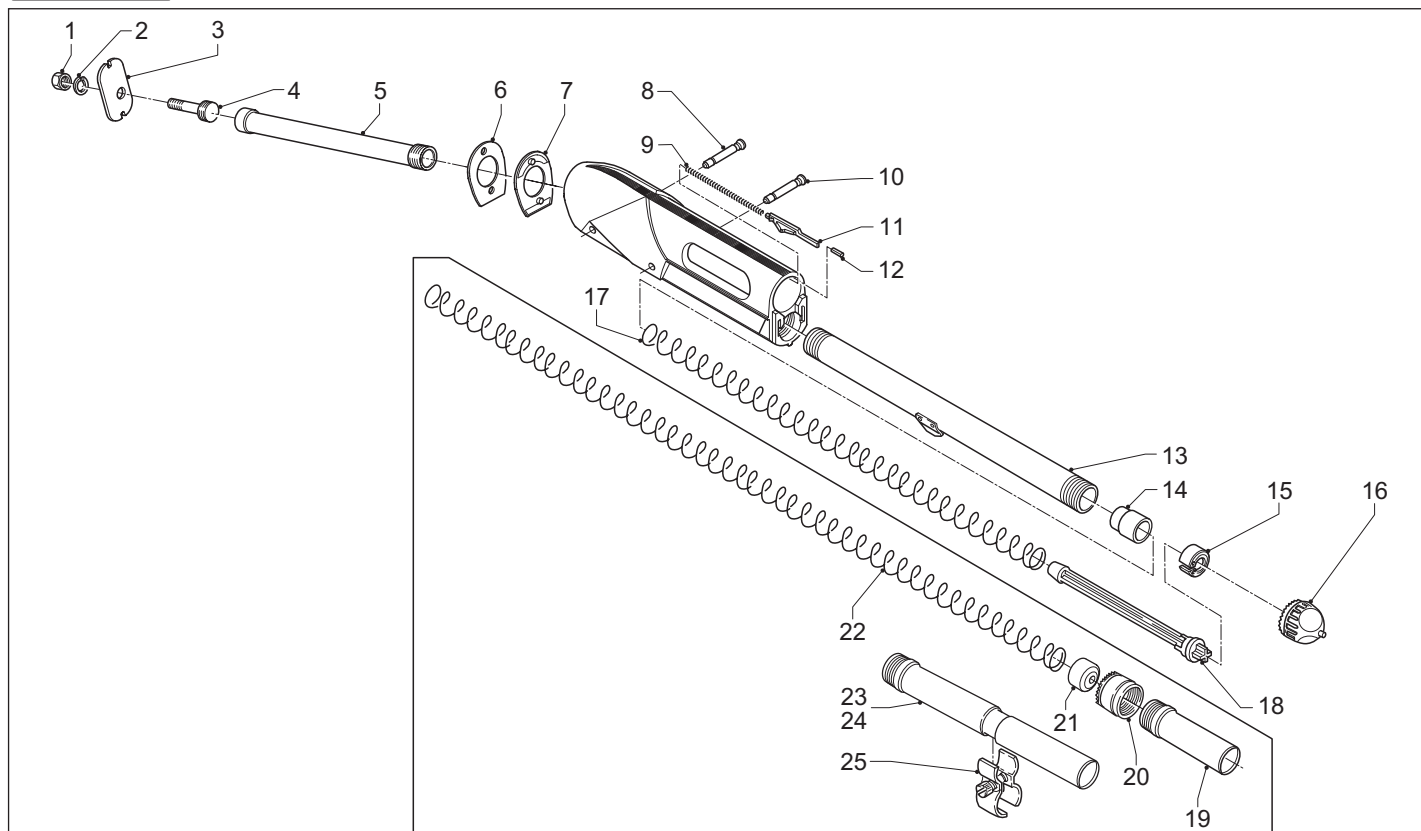



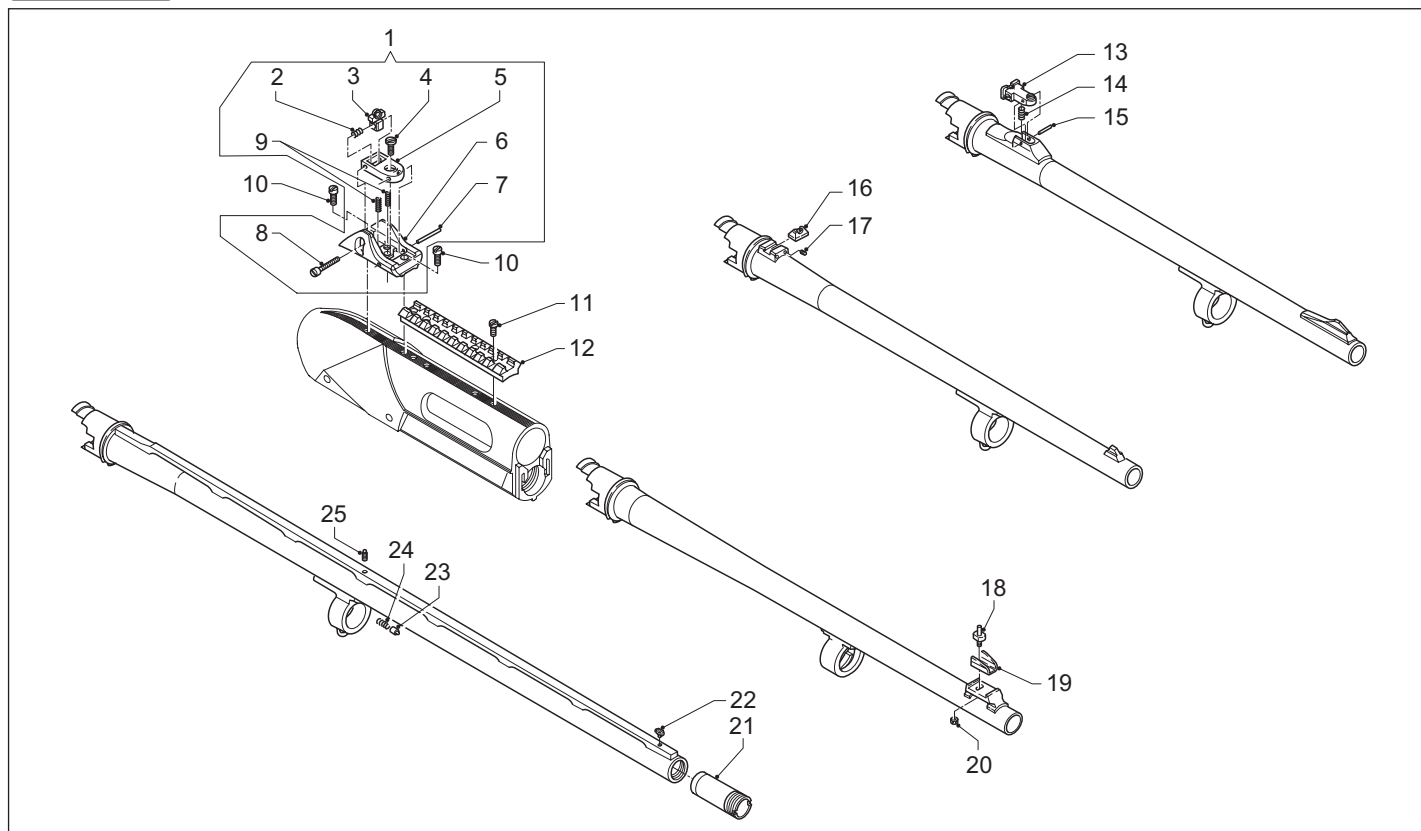





Pos. No.	Code SuperNova	Code Nova 12GA	Code Nova 20GA	Description
1	127S	127C	127C	Rear sight assembly
2	258C	258C	258C	Windage spring
3	253C	253C	253C	Rear sight aperture
4	255C	255C	255C	Elevation adjustment screw
5	254C	254C	254C	Elevation platform
6	126S	126C	126C	Rear sight base
7	257C	257C	257C	Sight pin
8	256C	256C	256C	Windage adjustment screw
9	259C	259C	259C	Elevation spring
10	128C	128C	128C	Rear sight screw
11	128S	128C	–	Telescope screw
12	260N	260N	–	Telescope guide
13	127N	127N	127N	Rear sight
14	259N	259N	259N	Rear sight spring
15	035A	035A	035A	Spring pin
16	042C	042C	042C	Rear sight
17	043C	043C	043C	Rear sight screw
18	110C	110C	110C	Front sight
19	111F	111F	111F	Front sight protection guard
20	113J	113J	113J	Front sight self-locking nut
21	213B	213B	213D	Internal choke
22	044N	044N	044N	Front sight
23	074J	074J	074J	Cap retaining pin bushing

[illegible]

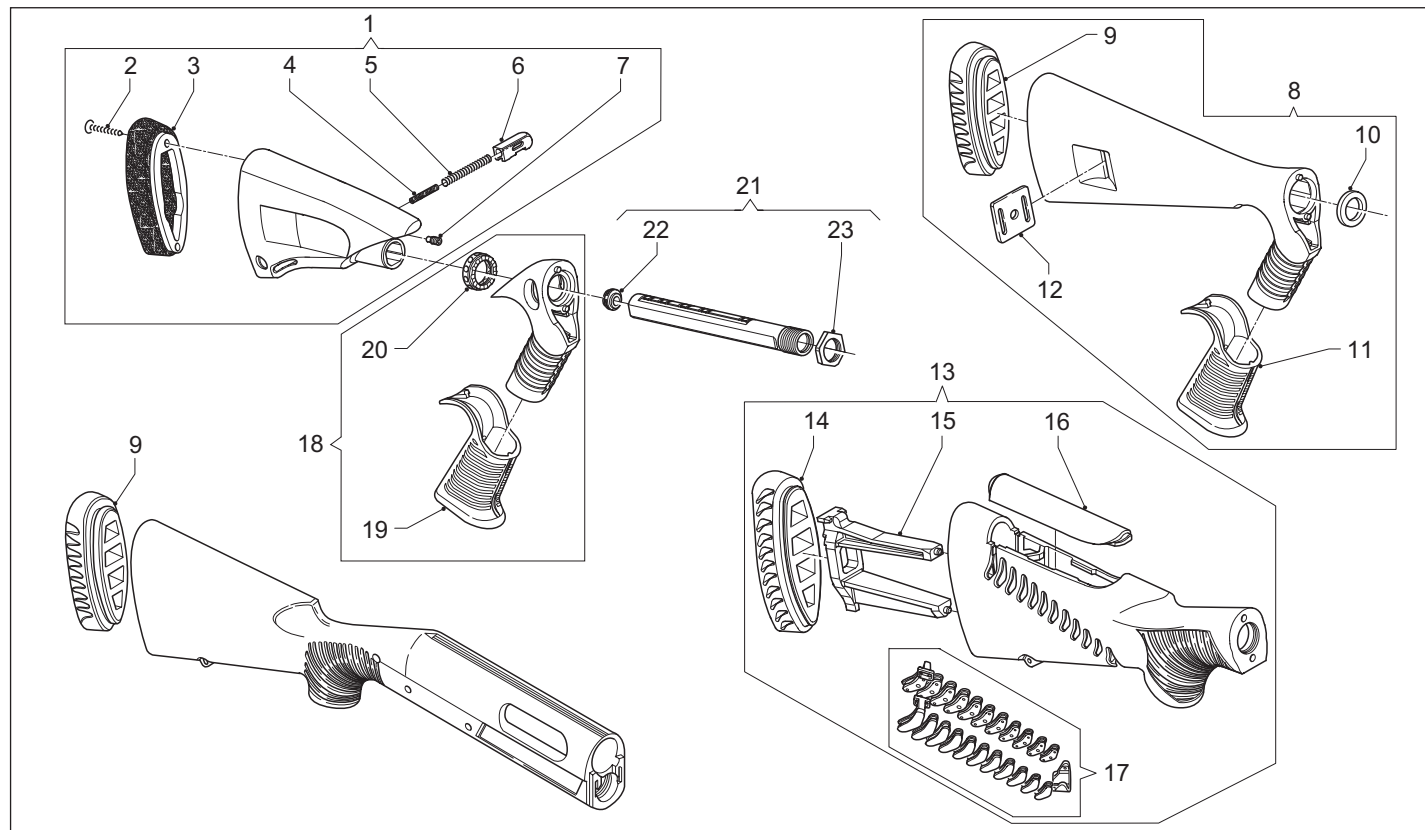



Pos. No.	Code SuperNova	Code Nova 12GA	Code Nova 20GA	Description
1	265S	–	–	Telescoping stock assembly
2	062C	–	–	Self-threaded screw
3	061C	–	–	Rubber butt plate
4	395S	–	–	Stock clickstop pin
5	004A	–	–	Button spring
6	108S	–	–	Button
7	224N	–	–	Action bar retaining pin
8	160C	–	–	Pistol-grip stock assembly
9	151T	151N	151T	Rubber butt plate
10	075C	–	–	Ring
11	083C	–	–	Grip
12	063C	–	–	Swivel plate
13	159S	–	–	Comfortech stock assembly
14	394G	–	–	Recoil pad
15	149C	–	–	Spacer
16	380S	–	–	Gel comb
17	379G	–	–	Chevrons assembly
18	117S	–	–	Pistol grip handle assembly
19	083J	–	–	Rubber grip
20	075S	–	–	Pistol-grip locking ring nut
21	166S	–	–	Stock tube assembly
22	050J	–	–	Tube cap
23	075J	–	–	Ring nut

Pos. No.	Code SuperNova	Code Nova 12GA	Code Nova 20GA	Description

